

PROPOSED SUBDIVISION - OPTION 1

LOTS 11, 12, 130, 197, 420 & 14893
STRATHERNE AND EAST PINGELLY

JOB REFERENCE: 100867 DATE: 8th JUNE 2012

THE DOCUMENT MAY ONLY BE USED FOR THE PURPOSE FOR WHICH IT WAS COMMISSIONED AND IN ACCORDANCE WITH THE TERMS OF ENGAGEMENT FOR THE COMMISSION. UNAUTHORISED USE OF THIS DOCUMENT IN ANY FORM WHATSOEVER IS PROHIBITED.

NOTE:
Areas and dimensions subject to survey.

LEGEND
 SUBJECT LAND

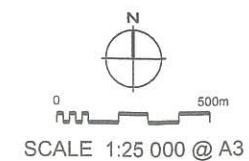

GRAY & LEWIS
 LAND USE PLANNERS

Suite 5, 2 Hardy Street
 South Perth, WA 6151
 T (08) 9474 1722
 F (08) 9474 1172
 perth@graylewis.com.au



PROPOSED SUBDIVISION - OPTION 2
LOTS 11, 12, 130, 197, 420 & 14893
STRATHERNE AND EAST PINGELLY

JOB REFERENCE: 100867 DATE: 8th JUNE 2012

THE DOCUMENT MAY ONLY BE USED FOR THE PURPOSE FOR WHICH IT WAS COMMISSIONED AND IN ACCORDANCE WITH THE TERMS OF ENGAGEMENT FOR THE COMMISSION. UNAUTHORISED USE OF THIS DOCUMENT IN ANY FORM WHATSOEVER IS PROHIBITED.

NOTE:
 Areas and dimensions subject to survey.

LEGEND
 SUBJECT LAND

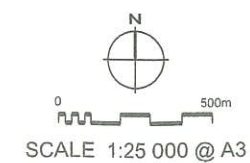

Suite 5, 2 Hardy Street
 South Perth, WA 6151
 T (08) 9474 1722
 F (08) 9474 1172
 perth@graylewis.com.au

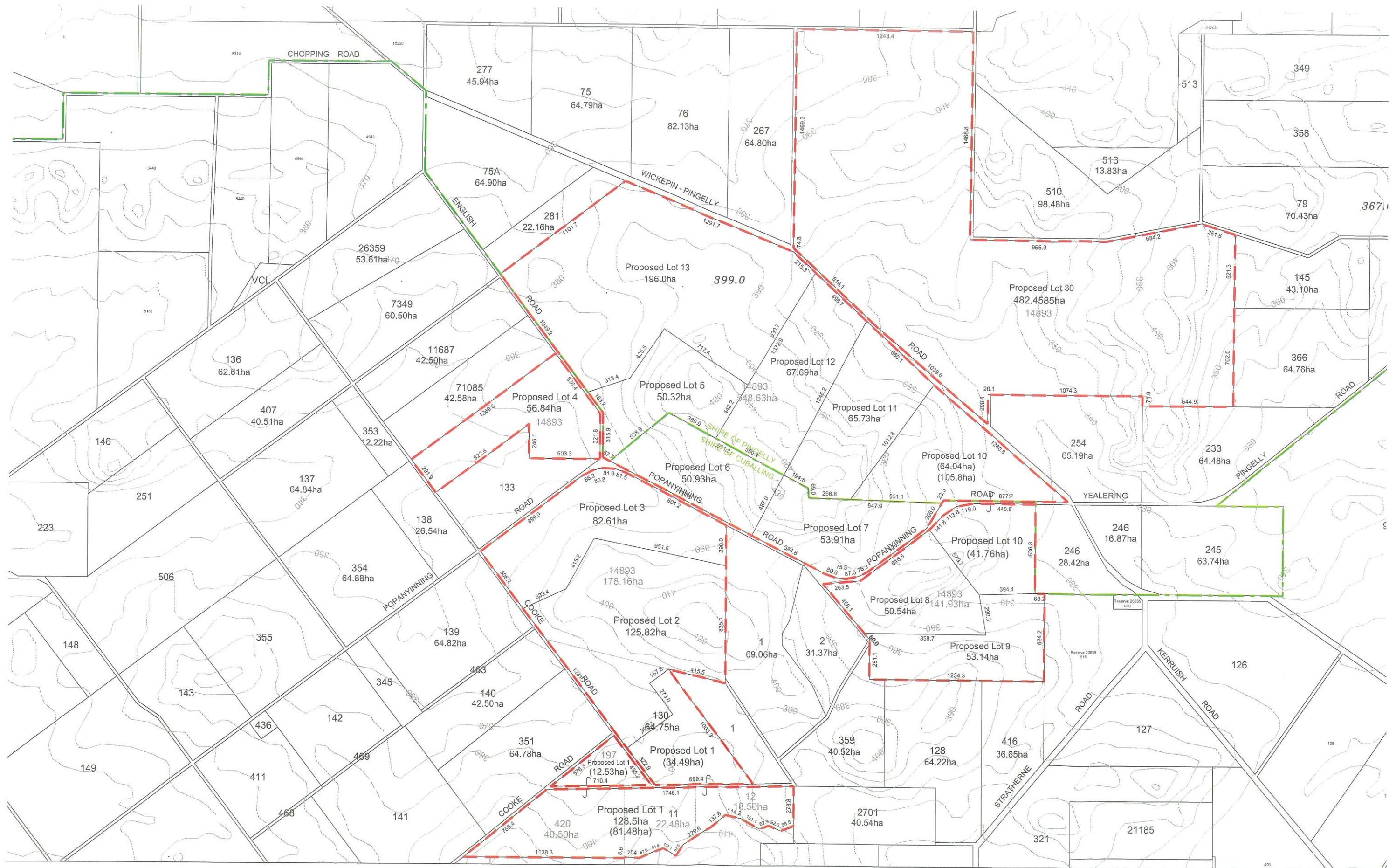

PROPOSED SUBDIVISION - OPTION 2

LOTS 11, 12, 130, 197, 420 & 14893
 STRATHERNE AND EAST PINGELLY

JOB REFERENCE: 100867 DATE: 8th JUNE 2012

THE DOCUMENT MAY ONLY BE USED FOR THE PURPOSE FOR WHICH IT WAS COMMISSIONED AND IN ACCORDANCE WITH THE TERMS OF ENGAGEMENT FOR THE COMMISSION. UNAUTHORISED USE OF THIS DOCUMENT IN ANY FORM WHATSOEVER IS PROHIBITED.

NOTE:
 Areas and dimensions subject to survey.

LEGEND
 SUBJECT LAND

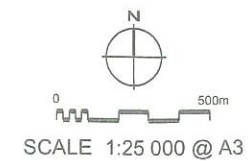

GRAY & LEWIS
 LAND USE PLANNERS

Suite 5, 2 Hardy Street
 South Perth, WA 6151
 T (08) 9474 1722
 F (08) 9474 1172
 perth@graylewis.com.au